

## 7 Assembly Instructions

### 7.1 The MTB bike frame

#### Seat post assembly

Consider max. allowed seat post length (x) including min. insert length (y):

120 mm (y) at 400 mm (x)

120 mm (y) for adjustable seat post (e.g. RockShox Reverb) with max. 420mm (x)

110 mm (y) at 380 mm (x)

100 mm (y) at 350 mm (x)

For seat post assembly apply carbon assembly paste to seat post and to the inside of seat tube. It is not allowed to use standard grease!

Consider torque on seat clamp and seat post!

⌚ Max. 6 Nm (apply gradually)

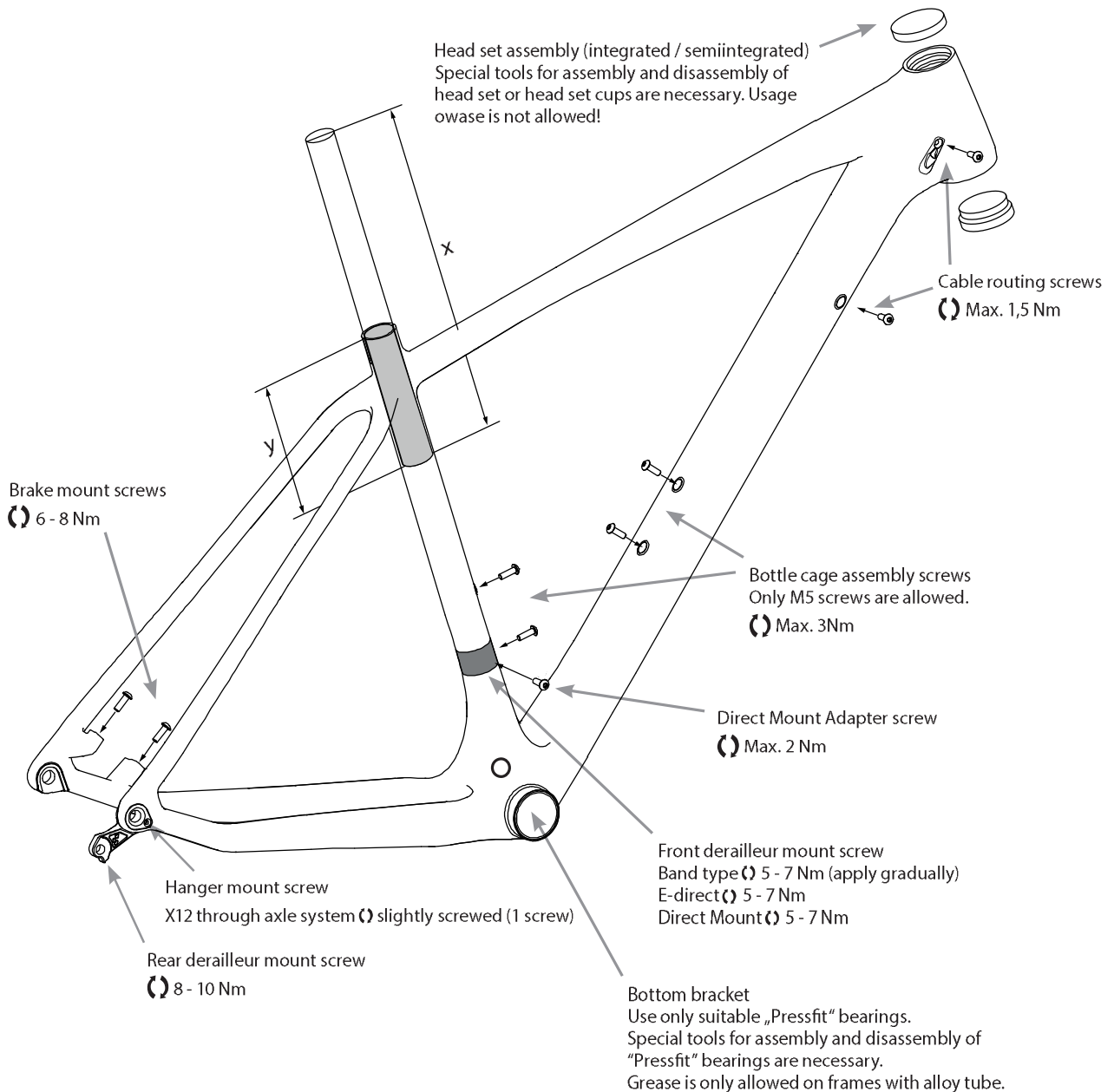

## 7.2 The racing bike frame

### Seat post assembly

Consider max. allowed seat post length (x) including min. insert length (y):  
100 mm (y) at 350 mm (x)

For seat post assembly apply carbon assembly paste to seat post and to the inside of seat tube. It is not allowed to use standard grease!

Consider torque on seat clamp and seat post!

(⌚) Max. 6 Nm (apply gradually)

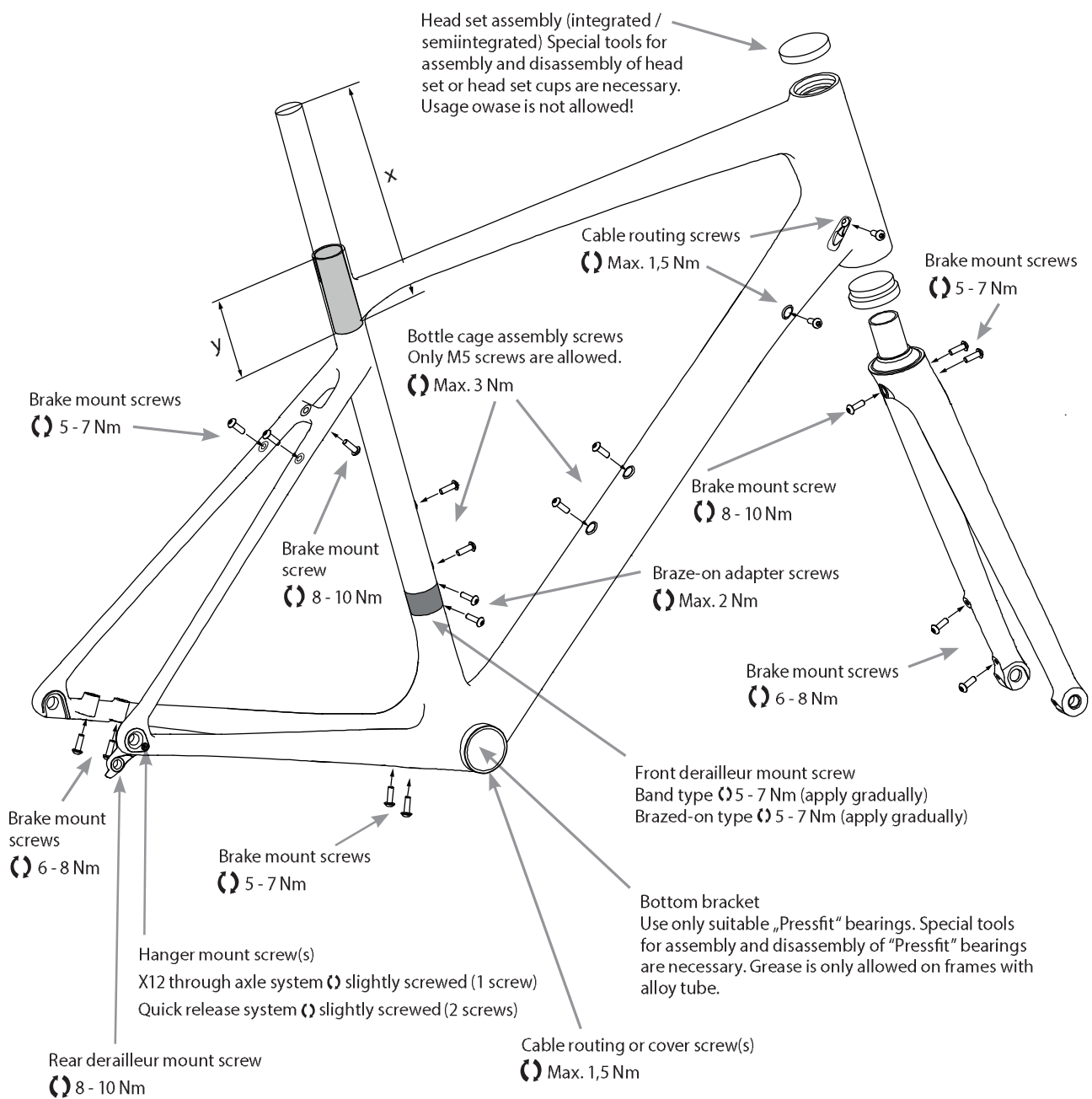

## 8 Liability



### **Risk of Personal Injury and Material Damage!**

**The manufacturing company accepts no liability for accident damage or consequential loss. The user bears the risk in the event of personal injury and material damage. The manufacturing company accepts no liability for damage or accidents caused by improper use of the frame and failure to comply with the stipulations indicated here.**